

6V 34W

HRL 634W F2FR

HRL 634W F2FR is specially designed for high efficient discharge and long life application. It's characteristics are small volume, light weight and high discharge efficiency. It can be used for more than 260 cycles at 100% discharge in cycle service, or five to eight years in standby service.



Specification

Cells per unit	3
Voltage per unit	6
Capacity	34W @ 15minute-rate to 1.67V per cell @25°C(77°F)
Weight	Approx. 1.38kg(3.05 lbs)
Maximum Discharge Current	130A(5sec)
Internal Resistance Approx.	Approx. 10mΩ
Operating Temperature Range	Discharge: -20°C ~50°C (-4°F~122°F) Charge: 0°C ~40°C (32°F~104°F) Storage: -20°C ~40°C (-4°F~104°F)
Nominal Operating Temperature Range	25°C±3°C (77°F±5°F)
Float Charging Voltage	6.75 to 6.9 VDC/unit Average at 25°C(77°F)
Recommended Maximum Charging Current Limit	3.4A
Equalization and Cycle Service	7.2 to 7.5 VDC/unit Average at 25°C(77°F)
Self Discharge	CSB Batteries can be stored for more than 6 months at 25°C (77°F). Please charge batteries before using. For higher temperatures the time interval will be shorter.
Terminal	Faston Tab 250
Container Material	-ABS (UL94-VO Flame Retardant Case).



CSB-manufactured batteries are UL-recognized components under UL924 as well as ISO 9001 and ISO 14001 certified.

Dimensions

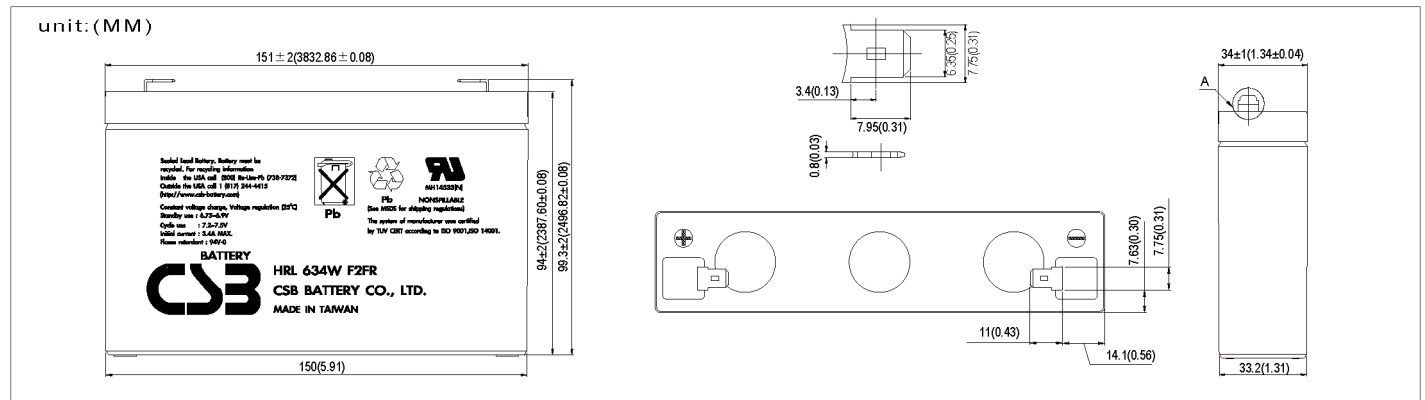

Constant Current Discharge Characteristics Unit:A(25°C,77°F)

F.V/Time	2MIN	4MIN	6MIN	8MIN	10MIN	15MIN	20MIN	30MIN	60MIN	90MIN
1.60V	60.4	47.4	36.2	30.9	26.6	18.7	14.4	11.3	5.84	4.66
1.67V	57.3	44.7	33.9	29.3	25.2	18.6	14.3	11.1	5.80	4.63
1.70V	55.9	43.5	32.9	28.6	24.6	18.5	14.2	11.0	5.78	4.62
1.75V	52.4	40.7	30.9	27.0	22.8	18.3	14.1	10.9	5.74	4.57
1.80V	48.9	37.9	28.9	25.4	21.0	18.1	13.9	10.8	5.69	4.52
1.85V	45.4	35.1	26.9	23.8	19.2	17.9	13.8	10.7	5.65	4.47

Constant Power Discharge Characteristics Unit:Watt(25°C,77°F)

F.V/Time	2MIN	4MIN	6MIN	8MIN	10MIN	15MIN	20MIN	30MIN	60MIN	90MIN
1.60V	327	260	203	175	150	110	84.0	65.5	34.6	27.7
1.67V	312	246	190	167	143	109	82.6	65.2	34.5	27.6
1.70V	305	240	185	163	140	108	82.0	65.0	34.4	27.5
1.75V	292	228	175	155	133	104	81.0	64.3	34.2	27.3
1.80V	278	215	165	147	125	100	80.0	63.5	33.9	27.1
1.85V	265	203	155	139	118	96.0	79.0	62.8	33.7	26.9

- All mentioned values are average values.
- Low rate discharge mode (over 90 mins.) is not recommended.

Trickle (or Float) Service Life

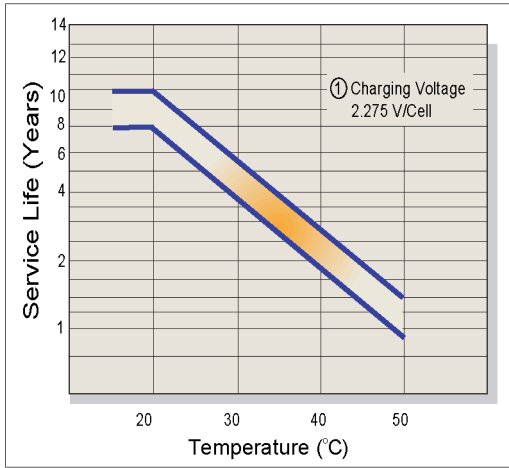

Capacity Retention Characteristic

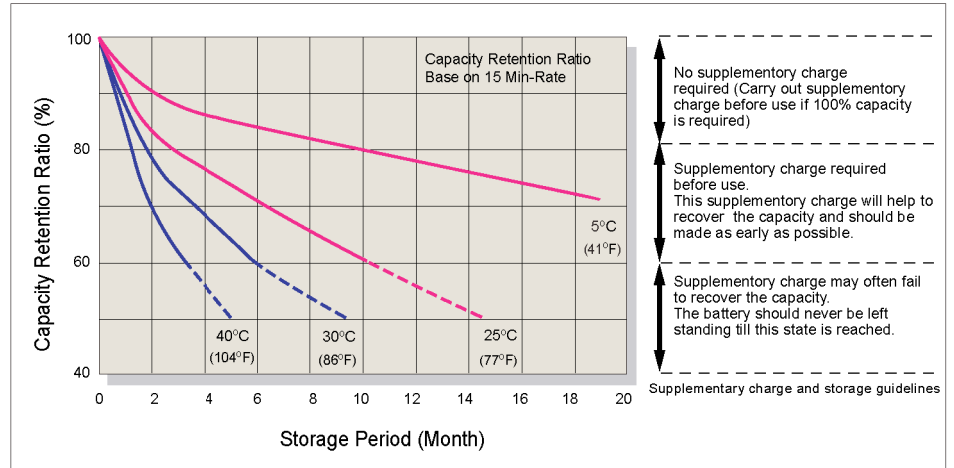

Battery Voltage and Charge Time for Standby Use

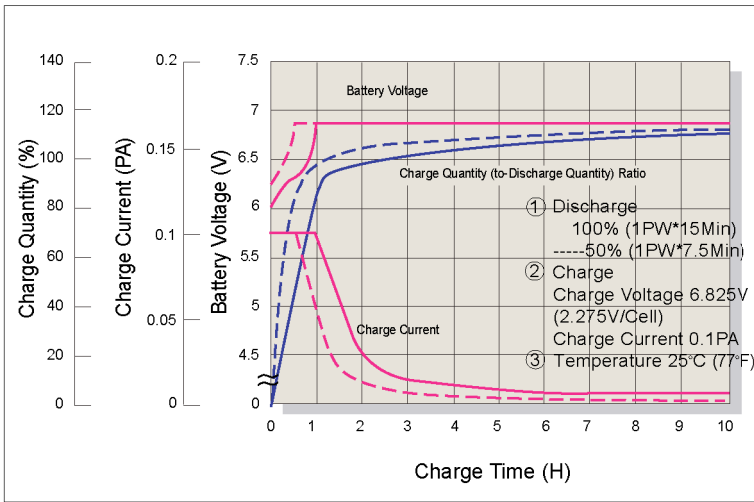

Cycle Service Life

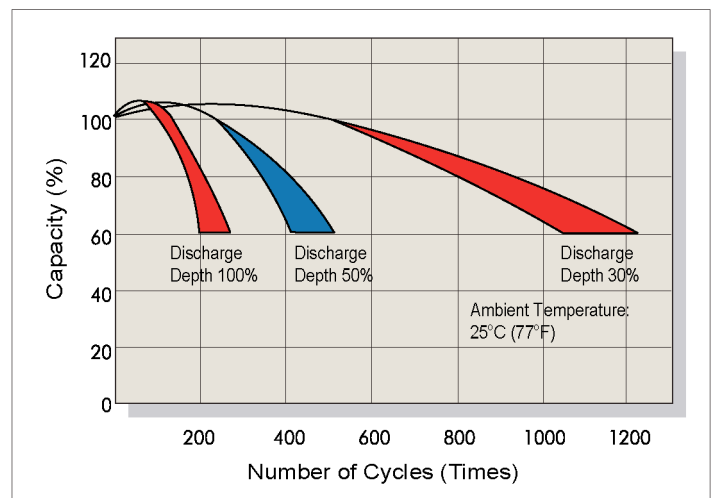

Battery Voltage and Charge Time for Cycle Use

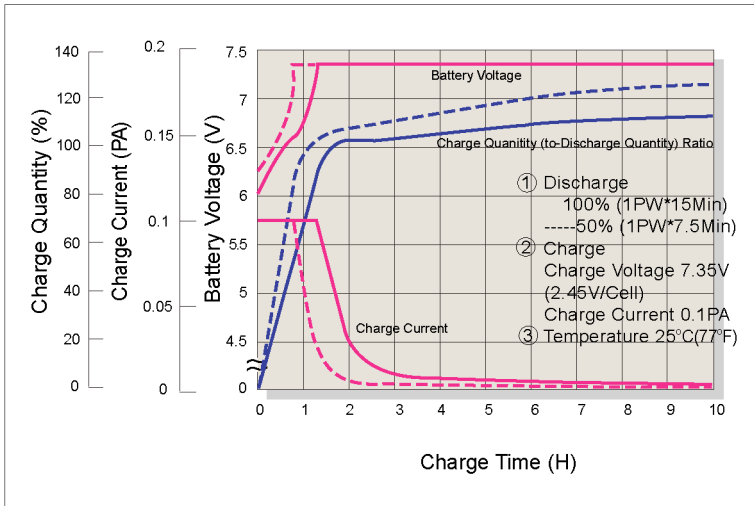

Terminal Voltage (V) and Discharge Time (25°C/77°F)

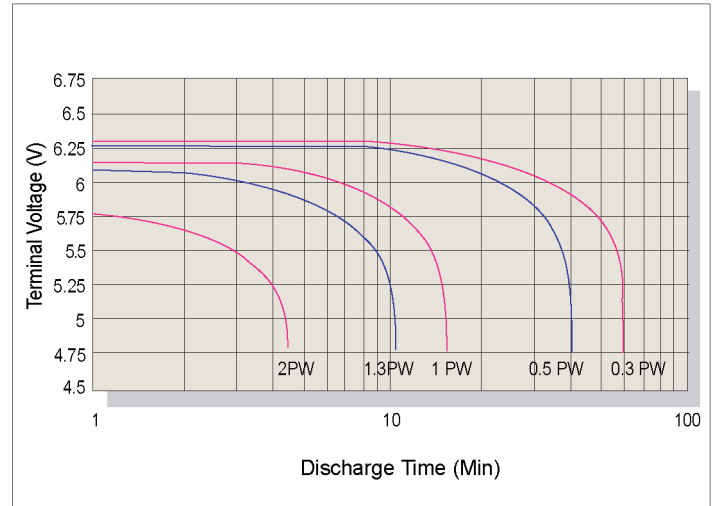

Charging Procedures

Application	Charge Voltage (V/Cell)			Max. Charge Current
	Temperature	Set Point	Allowable Range	
Cycle Use	25°C (77°F)	2.45	2.40~2.50	0.1PA
Standby	25°C (77°F)	2.275	2.25~2.30	